

CCPRF
 NOV 29 - DEC 3, 2023
 TOWN & COUNTRY SAN DIEGO
 GOLDEN STATE HALL
 SAN DIEGO, CA



2575 NORTHWEST PKWY
 ELGIN, IL 60124
 P: 847.426.3100
 F: 847.426.3111
 www.vipertradeshow.com

DATE
 1.13.23

BOOTH COUNTS
 ALL BOOTHS ARE 10' X10'
 UNLESS NOTED

10 x 10 = 25
 10 x 20 = 11
 20 x 20 = 8

POSTERS = 40

KEY
 FE-FIRE EQUIPMENT
 ALL EXITS 6' UNLESS NOTED
 ALL DRAPE USED MEETS
 FLAME RETARDANT FIRE CODE

SHOW INFO
 SHOW OPENS:
 SHOW CLOSES:
 MOVE IN:
 MOVE OUT:
 CONTACT:
 PHONE:

CAPACITY INFO
 GUESTS: N/A
 TOTAL SQ FT: 40700
 USABLE SQ FT: 40700
 MAX OCCUPANCY: 2713
 MAX ALLOWED OCCUPANCY: 2713
 EXIT FEET REQ'D: 45'
 FIRE EXITS GIVEN: 120'
 FIRE EXTINGUISHERS REQ: 13
 FIRE EXTINGUISHERS GIVEN: 8

DRAWN BY
 M. MOSES

SCALE
 1" = x UNITS

DISCLAIMER
 Every effort has been made to ensure the accuracy of all information contained on this floor plan. However, no warranty, either expressed or implied, are made with respect to the accuracy or completeness of the information. The user of this information is responsible for verifying all dimensions and locations.

Doors that are blocked or unavailable and are not needed to meet the minimum exit requirement will have exit signs covered.

There will be no condition, pre-emption or open flames that have not been properly permitted used in this event.

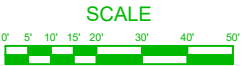
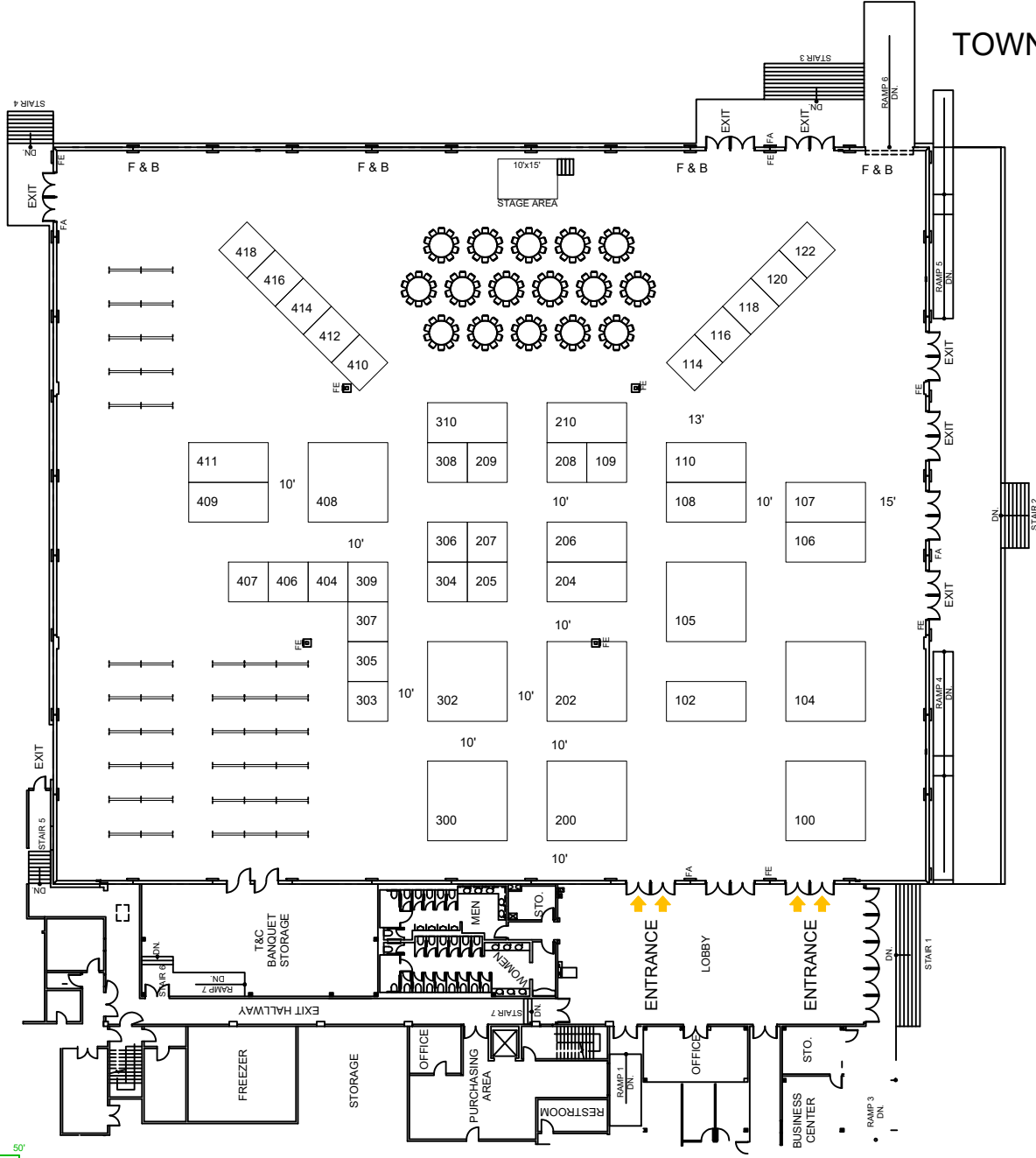

ROOM
 MAX OCCUPANCY 40700 sqft divided by 15 = 2713
 Linear footage of exits REQUIRED, 2713 divided by 60 = 45'
 Fire Exits Req: 2713 Times .02 = 52'
 Fire Exits Given: 120'
 Fire Extinguishers Req: 40700 sqft divided by 3000 = 13
 Fire Extinguishers Given: 8